



PLUG-IN → PROMOTION

Fiji LDFI-19

JBG2



Cross sections:

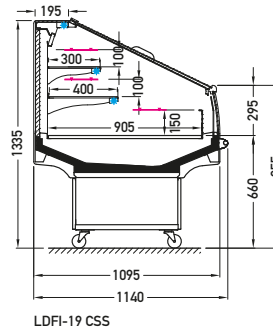
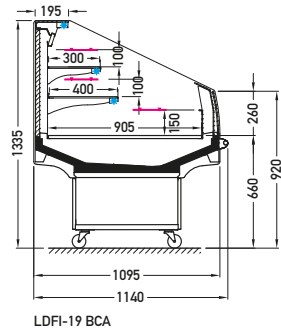

BCA – low glass or front glass riser | single, bent | fixed

CSS – cover | single, straight | sliding (sideways)



Modules:

BCA 1250 1600

CSS 1250



Temperature class:

BCA – 3M2

CSS – 3M1



Refrigerant:

R290



Standard features:

- working temperature: from 2°C to 4°C for BCA, from 0°C to 2°C for CSS
- electrical defrosting
- automatic evaporation of condensate
- electronic controller with temperature indicator
- **energy saving fans**
- exposition: zinc-plated steel, powder painted in white (RAL 9003)
- Ø25 inox bumper
- colour of the base black (RAL 9005)
- SIDEWALLS glass with black/grey silk screen painting
- on wheels